

## I SPRAT

**STAN - 7**  
**JEDNOSOBAN STAN**  
**NETO POVRŠINA 38,76m<sup>2</sup>**

ULAZ / HODNIK 4,41m<sup>2</sup>

KUPATILO 4,18m<sup>2</sup>

KUHINJA 6,01m<sup>2</sup>

DNEVNI BORAVAK,  
 TRPEZARIJA 10,73m<sup>2</sup>

SPAVAĆA SOBA 9,43m<sup>2</sup>

TERASA 4,00m<sup>2</sup>

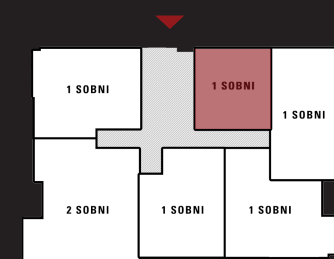

**ENTEXT**  
 I N V E S T